

NORTH

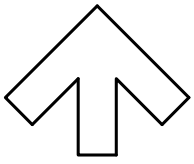

**General Notes**

This information forms part of the building construction package and is to be read in conjunction with all relevant Architectural drawings and details, the specification for the works, the relevant Consultants details, together with any other specialist details. Any discrepancies to be reported and resolved prior to continuing work on site.

**Health & Safety Information**

These details have been prepared with due consideration for safety during construction, occupation and maintenance of the finished project. The works contain no extraordinary hazards or risks that are not present during routine construction operations or would readily be apparent to a competent contractor. Whilst every effort has been made to design out all risks associated with this project some may still exist:

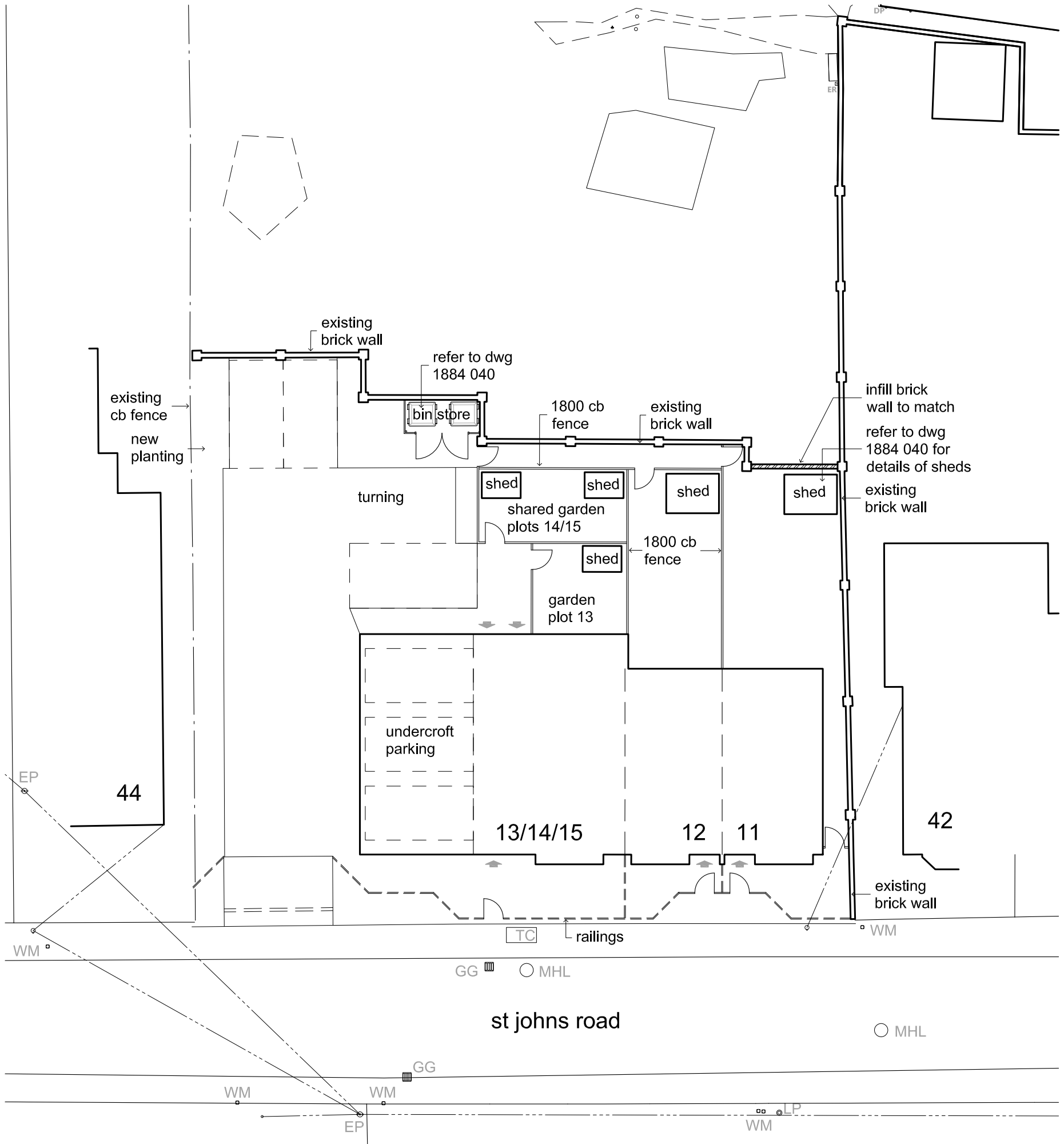

**Accommodation**

- 2no. 2 bed 4 person houses @ 67m<sup>2</sup>
- 1no. 1 bed 2 person flat @ 50.5m<sup>2</sup>
- 1no. 1 bed 2 person flat @ 51m<sup>2</sup>
- 1no. 1 bed 2 person flat @ 58m<sup>2</sup>

Total 5no. dwellings

Total 6no. parking spaces

details based on information provided by Fielden Ltd

**construction issue**

**Site Plan** - to be read in conjunction with approved hard & soft landscaping drawings

**Project:** Proposed Housing Development  
Fairfield Rd, Saxmundham

**Client:** Fox Construction

The Studio  
Drinkstone Office Park  
Kempson Way  
Bury St Edmunds  
Suffolk IP32 7AR



**Drwg:** 1884 BR.C 101 **Revision:**  
**Date:** December 2023 **Scale:** 1:200 @A3

Tel: 01284 756166  
Email: rp@reespryer.co.uk